

BREAKDOWN

HARDWARE ELEMENTS:

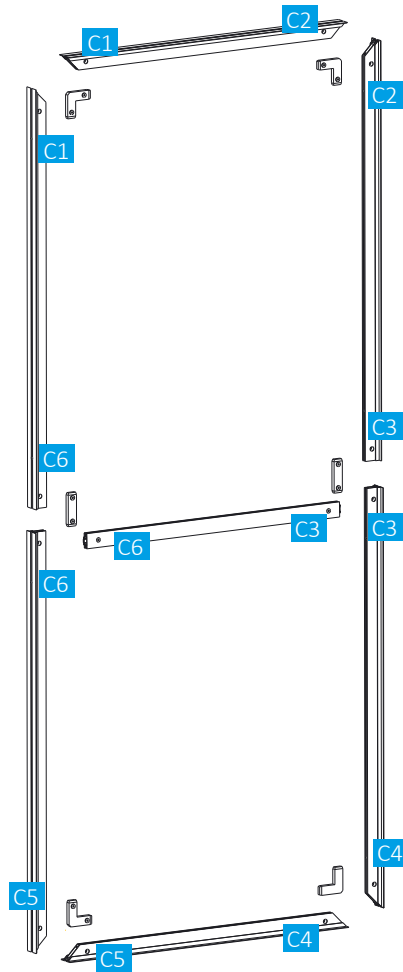

- 4 sections (LN612) 1250mm



- 2 sections (LN612) 950mm



- 1 section (EX605) 860mm + 2 locks (FX617)



- 2 locks (IB2)



- 4 corner locks (CB9)



- 4 connecting screws vector to vector (ST230)

Etape 4

frame to pole assembly

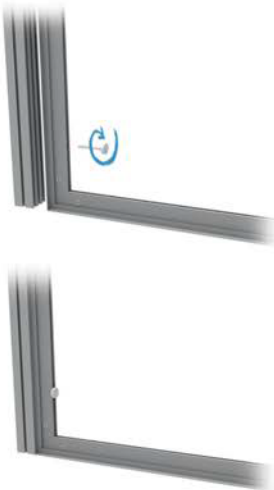

- use square pole to connect 2 frames in 90°



Etape 5

2 frames assembly

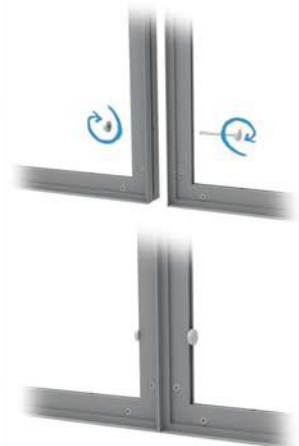

- the frame can be positioned side by side or one above the other



» Frame to pole screw
(ST231)



• "Allen" Key
multifunctional
(LN127)



• "Allen" Key
5 mm



» Frame to frame screw
(ST230)

Module 1M

code : **MODULE-VFF-C**

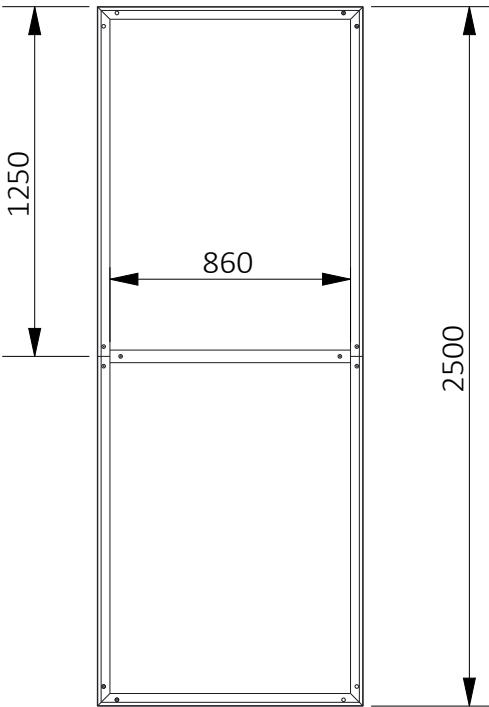
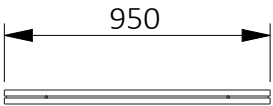

SYSTEM FEATURES	GRAPHICS FEATURES	ADDITIONAL INFORMATION
<p>Overall dimensions (mm): 2500(h) x 950(w) x 50(d)</p> <p>Weight 8,6kg (1 pack)</p>	<p>Visible area of the graphic (mm): 2497(w) x 947(sz) *Ensure an allowance of 5cm, to all sides inside the graphic, without any text or logo</p> <p>About graphics:</p> <ul style="list-style-type: none"> • We recommend to print on a stretch fabric • The gasket on the edge of the printed graphic should be 12x3mm 	<ul style="list-style-type: none"> • Standard holes on each side of the frame to connect it to a pole (provide connecting screw vector to pole ST231) • 4 screws vector to vector (ST230) included with the vector frame • Découpes max de 1250mm